

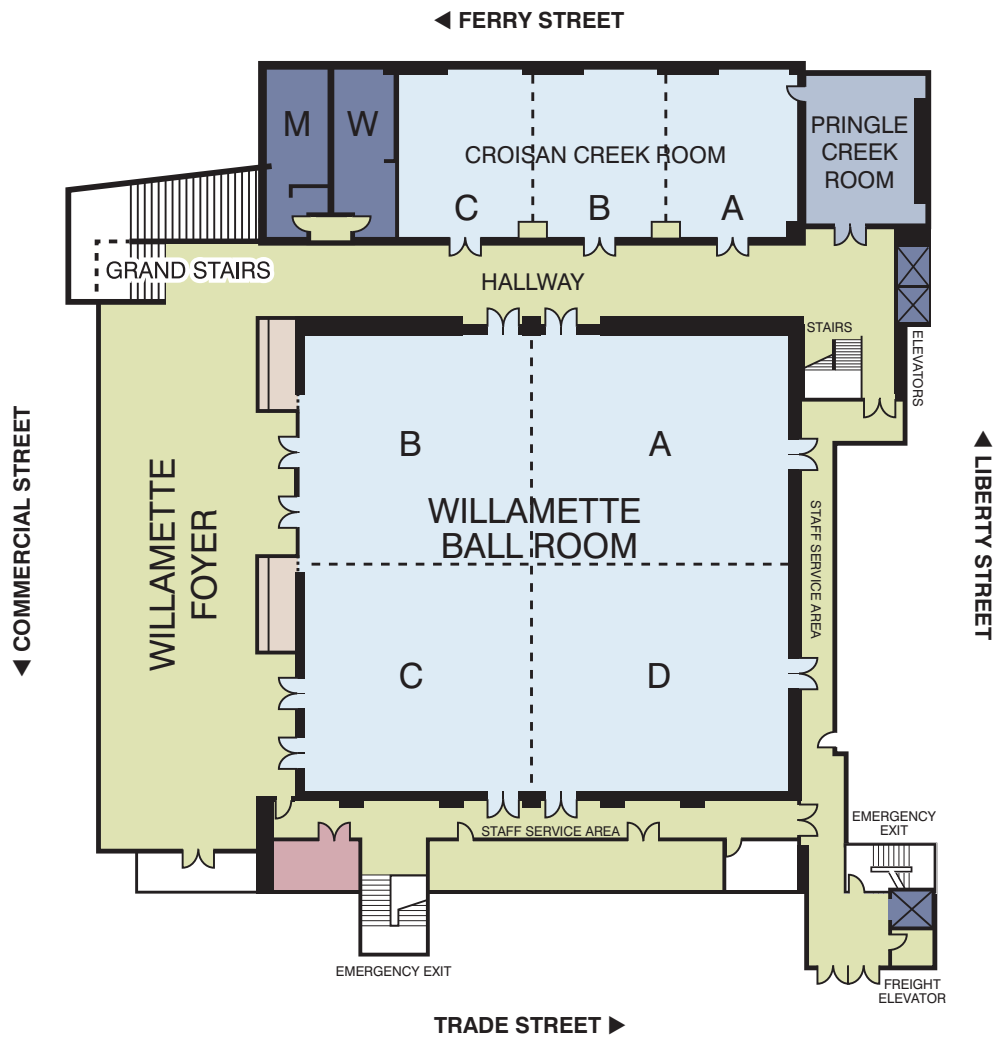

**SALEM  
CONVENTION  
CENTER**

# SECOND FLOOR



	SQFT	DIMENSIONS	ROUNDS	CLASSROOM	THEATER	U-SHAPE	H/SQUARE
<b>Willamette Foyer</b>	3000	100' x 30'	-	-	-	-	-
<b>Willamette Ballroom (24' Ceiling)</b>	11,400	103'4" x 109'10"	900	640	1500	-	-
<b>Willamette A</b>	3000	51'8" x 57'11"	160	140	400	48	64
<b>Willamette B or C</b>	2700	51'8" x 57'11"	160	140	400	48	64
<b>Willamette AD</b>	6000	103'4" x 57'11"	400	320	800	80	110
<b>Willamette BC</b>	5400	103'4" x 57'11"	400	280	750	80	110
<b>Willamette AB or CD</b>	5700	51'8" x 109'10"	400	280	750	80	110
<b>Hallway</b>	2499	160' x 15"	-	-	-	-	-
<b>Croisan Creek (15' Ceiling)</b>	3240	37'8" x 90'1"	200	160	260	-	-
<b>Croisan A, B or C</b>	1080	37'8" x 30'5"	60	48	80	24	32
<b>Croisan AB or BC</b>	2160	37'8" x 60'5"	120	96	160	48	56
<b>Pringle Creek</b>	900	27' x 34'1"	50	40	80	22	26